

Prensaestopas de NYLON con protector de cable E 186042



Material: Nylon 66 homologado UL 94V-2.

Color: ■ Negro.

Ref.	Orificio de montaje D1	Dimensiones mm.						Para cable	
		Paso	D2	B1	L1	L2	L3		
AG-12SR	12	1.25	8.3	6.0	7.9	12.1	53.3	3-6.5	50
AG-16SR	16	1.5	10.9	9.6	14.4	14.4	74.9	5-10	50
AG-20SR	20	1.5	14.8	12.9	12.8	19.5	96.2	10-14	50
AG-25SR	25	1.5	18.5	16.5	13.9	19.5	111.2	13-18	25
EG-7SR	11.7	1.5	8.0	6.0	8.0	12.8	53.3	3.5-6	50
EG-9SR	14.3	1.5	9.9	7.0	8.1	13.9	62.5	4-8	50
EG-11SR	17.3	1.5	13.2	9.6	8.2	15.4	74.9	5-10	50
EG-13.5SR	19.3	1.5	15.2	11.7	8.9	15.8	85.5	6-12	50
EG-16SR	21.3	1.5	17.2	12.9	8.9	17.3	96.2	10-14	50
EG-21SR	27	1.5	22.4	16.5	10.8	18.6	111.2	13-18	25
AGJ-14SR	14	1.5	8.04	6.33	8.07	12.15	53.3	3-6.5	50
AGJ-17SR	17	1.5	10.76	10.25	14.63	14.53	74.9	5-10	50
AGJ-21SR	21	1.5	14.98	13.5	12.87	19.6	96.2	10-14	50
AGJ-27SR	27	1.5	18.37	18.65	14.66	18.45	111.2	13-18	25

Prensaestopas de NYLON E 186042



Sistema métrico

IP68

Ref.	Orificio de montaje D1	Dimensiones mm.						Para cable	
		Paso	D2	B1	L1	L2	L3		
AG-12	12	1.25	8.3	6.0	7.9	12.1	13.3	3-6.5	50
AG-16	16	1.5	10.9	9.6	15.7	14.4	16.7	5-10	50
AG-20	20	1.5	14.8	12.9	15.0	19.5	18.4	10-14	50
AG-25	25	1.5	18.6	16.4	15.0	18.7	22.3	13-18	50
AG-32	32	1.5	26	23.4	14.7	20.3	26.2	18-25	25
AG-40	40	1.5	33	30.6	17.7	23.4	31.9	22-32	10
AG-50	50	1.5	41.2	38.2	17.3	25.7	31.6	30-38	10
AG-16F	20.8	PF1/2"	11	13	9.5	14.0	18.7	5-10	50
AG-20F	20.8	14	14.7	14.7	9.5	16.0	18.5	6-13	50

Sistema JIS

Ref.	Orificio de montaje D1	Dimensiones mm.						Para cable	
		Paso	D2	B1	L1	L2	L3		
AGJ-14	14	1.5	8.04	6.33	8.07	12.15	13.3	3-6.5	50
AGJ-17	17	1.5	10.76	10.25	14.63	14.53	16.7	5-10	50
AGJ-21	21	1.5	14.98	13.50	12.87	19.60	18.4	10-14	50
AGJ-27	27	1.5	18.37	18.65	14.66	18.45	22.3	13-18	50
AGJ-34	34	1.5	25.84	25.31	14.84	20.75	26.1	18-25	25

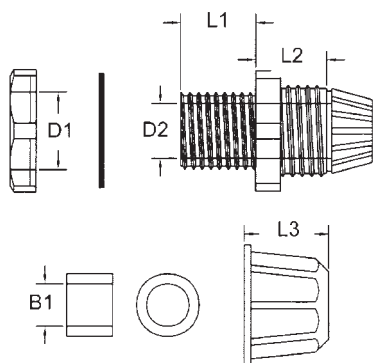

Material: Nylon 66 homologado UL 94 V-2.

Color standard: ■ -GR.

Otros colores: ■ -AZ, □ -BL, ■ -GC, ■ -IV,

■ -NG.

Pasacables adaptables



Ref.	Dimensiones mm.						
	A	B	C	D	E	F	
KB-1	19	13	14	6	8	10	50
KB-2	22	17.5	16.6	10	13	15	50

Material: PVC. Color: ■ Negro.

Basta eliminar las piezas opcionales no necesarias para la adaptación a los diferentes diámetros de cable.

Se utiliza para la fijación y protección de cables.

Prensaestopas de NYLON E 186042

IP68

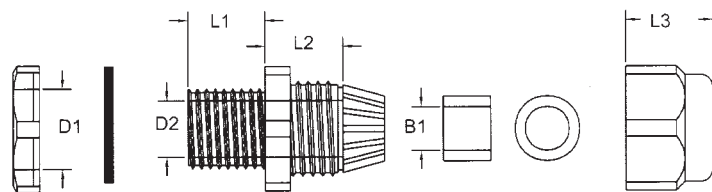

Ref.	Orificio de montaje D1	Dimensiones mm.						Para cable		
		Paso	D2	B1	L1	L2	L3			
EG-7	PG-7	12.1	1.5	8.0	6.0	8.0	12.8	13.4	3.5-6	50
EG-7LS	PG-7	MÁS PEQUEÑO	1.5	8.0	6.0	8.0	12.8	13.4	3.5-6	50
EG-9	PG-9	14.3	1.5	9.9	7.0	8.1	13.9	15.2	4-8	50
EG-9L	PG-9		1.5	9.9	7.0	14.67	13.9	15.2	4-8	50
EG-11	PG-11	18.23	1.5	13.2	9.6	8.2	15.4	18.3	5-10	50
EG-11L	PG-11		1.5	13.2	9.6	14.85	15.4	18.3	5-10	50
EG-13.5	PG-13.5	19.9	1.5	15.2	11.7	8.9	15.8	18.9	6-12	50
EG-13.5L	PG-13.5		1.5	15.2	11.7	15.63	15.8	18.9	6-12	50
EG-16	PG-16	22.1	1.5	17.2	12.9	8.9	17.3	19.7	10-14	50
EG-21	PG-21	27.5	1.5	22.4	16.5	10.8	18.6	23.9	13-18	50
EG-29	PG-29	36.2	1.5	30.6	23.3	10.9	20.5	27.4	18-25	25
EG-36	PG-36	46.7	1.5	35.2	33.3	14.4	24.4	30.5	22-32	10
EG-42	PG-42	52.2	1.5	39.3	39.6	14.6	25.4	31.6	30-38	10
EG-48	PG-48	57.6	1.5	45.4	45.1	15.8	25.2	31.3	34-44	10

Material: Nylon 66 homologado (UL) 94 V-2.

Color standard: ■ -GR.

Otros colores: ■ -AZ, □ -BL, ■ -GC, ■ -IV, ■ -NG.

Sistema PG. Standard DIN. Sin arandela

Arandelas reductoras



Material: Nylon 66 homologado  94V-2.

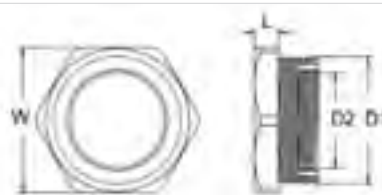

Ref.	Dimensiones mm.		L	W	
	D1	D2			
M2012	M20 x 1.5	M12 x 1.5	8.0	24.2	100
M2016	M20 x 1.5	M16 x 1.5	8.0	24.2	100
M2516	M25 x 1.5	M16 x 1.5	8.0	29.0	100
M2520	M25 x 1.5	M20 x 1.5	8.0	29.0	100
M3220	M32 x 1.5	M20 x 1.5	10.0	35.9	50
M3225	M32 x 1.5	M25 x 1.5	10.0	35.9	50
M4032	M40 x 1.5	M32 x 1.5	10.0	45.8	25
M5040	M50 x 1.5	M40 x 1.5	11.5	55.0	25
M6350	M63 x 1.5	M50 x 1.5	11.5	67.5	25

Presnaestopas de NYLON en ángulo recto

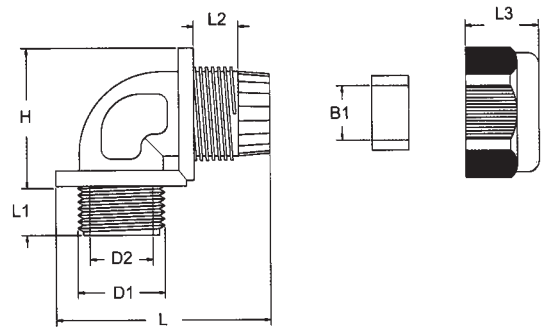

Material: Nylon 66 homologado (UL) 94 V-2. Color: ■ Negro.

Ref.	Orificio de montaje D1	Paso	Dimensiones mm.			L1	L2	L3	L	H	Para cable	
			D2	B1								
NPTA-38	16.6	NPT 3/8"	12	9.3	11.7	9.85	16.7	48.5	30	5-9	20	
NPTA-12	21	NPT 1/2"	14	13	14.7	11.75	18.4	51.6	31.2	10-13	20	
NPTA-34	26.3	NPT 3/4"	19.2	16.4	14.8	12.55	22.3	64.5	41.6	13-16	20	
NPTA-114	41.7	NPT 1 1/4"	31.6	29.3	18.8	16.25	31	85	53	22-29	10	

Protector "micro-switch"

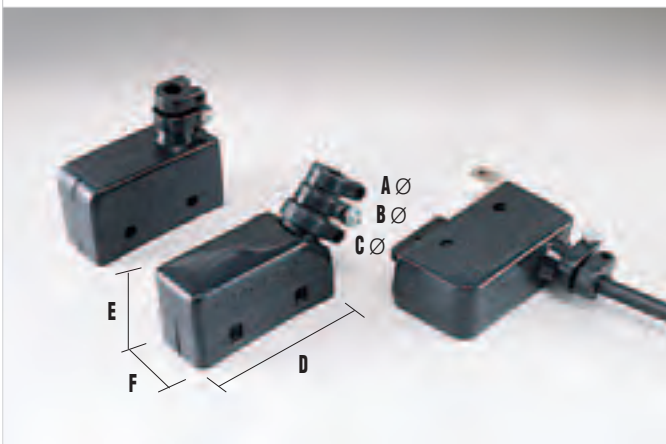



Material: PVC flexible. Color: ■ Negro.

Diseñado para la protección de micro-switch montados en maquinaria y de los cables contra posibles roturas. Disponibles en versión 45° y 90°.

Ref.	Tipo	Dimensiones mm.						
		A Ø	B Ø	C Ø	D	E	F	
CB-1	90°	7	9	-	49	27	19	50
CB-2	45°	7	9	11	49	27	19	50

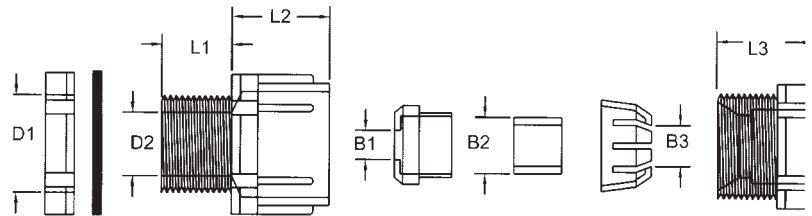
Prensaestopas de NYLON



Ref.	Orificio de montaje		Dimensiones mm.							Para cable	
	D1	Paso	D2	B1	B2	B3	L1	L2	L3		
PG-16	16	1.5	10.5		7	10	12	17	16.5	5-10	50
PG-20	20	1.5	13.7		9	13	13	19	19.5	6-13	50
PG-25	25	1.5	18.5		11	17	13	22	21	10-18	50
PG-32	32	1.5	25		15	20	15	24.5	24.5	16-22	25
PG-40	40	1.5	32	22	27	31	21	26.5	27.5	20-27	10
PG-50	50	1.5	41.5	32	36	41	23	30	31	30-41	10
PG-63	63	1.5	53.2	43	43	51	25	33	33	40-53	10

Material: Nylon 66 homologado (UL) 94V-2.

Color: ■ Negro.

Aislante y resistente al agua y a los golpes.

Para protección y fijación de cables en paneles.

Aplicación:

1. montar y fijar el cuerpo en el orificio del panel.
2. insertar los cables a través del cuerpo y las piezas de fijación y cierre.
3. apretar la tuerca de fijación para mantener el cable en posición.

Prensaestopas de NYLON con protector de cable

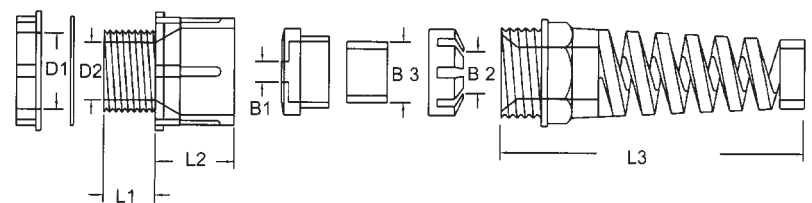

Ref.	Orificio de montaje		Dimensiones mm.							Para cable	
	D1	Paso	D2	B1	B2	B3	L1	L2	L3		
PG-1610	16	1.5	10.9	4.8	7	10	12	17	62	5-10	50
PG-2013	20	1.5	14.1	5.1	9	13	13	19	78	6-13	50

Material: Nylon 66 homologado (UL) 94V-2.

Color: ■ Negro.

Adaptador para tubos flexibles

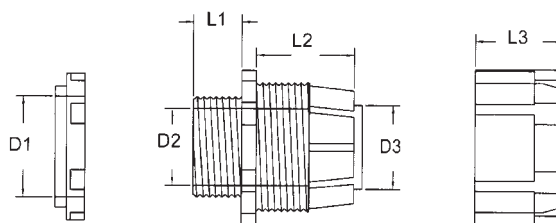

Material: Nylon 66 homologado UL 94V-2 . Color: ■ Gris. Construido en tres partes para la fijación de tubos flexibles en paneles de control, maquinaria, etc...
 Aplicación: 1. montar el cuerpo en el orificio del panel. 2. pasar el tubo a través de la tuerca de fijación. 3. insertar el tubo dentro de la grapa de sujeción y fijar con la tuerca para completar el montaje.

Ref.	Dimensiones mm.			L1	L2	L3	Para tubos	
	D1	D2	D3					
BG-16	15.9	11.0	10.8	10.0	17.9	15.7	BG-16P	50
BG-18	17.2	11.0	13.8	11.0	19.0	16.0	BG-18P (3/8")	50
BG-20	19.2	15.0	14.7	10.0	17.7	16.0	BG-20P	50
BG-22	20.6	14.8	17.2	11.0	19.0	16.0	BG-22P (1/2")	50
BG-25	23.1	18.0	19.6	11.3	23.4	21.0	BG-25P	50
BG-26	24.0	17.7	20.3	12.5	25.0	20.0	BG-26P (3/4")	50
BG-32	31.2	26.0	24.3	12.0	22.8	20.6	BG-32P	25
BG-34	32.5	25.8	28.7	12.5	25.0	21.0	BG-34P (1")	25
BG-40	37.5	31.5	31.6	11.3	23.6	20.7	BG-40P	25
BG-42	38.7	31.5	35.0	12.5	25.0	21.0	BG-42P (1 1/4")	25
BG-48	44.0	37.5	40.5	12.6	22.3	20.7	BG-48P	10
BG-50	44.0	37.5	39.5	12.6	21.6	20.7	BG-50P	10

Adaptador para tubos flexibles



Material: ABS. Color: ■ Gris.

Ref.	Tipo	Para tubos	
FAM-18	Tubo flexible /	BG-18P (3/8")	20
FAM-22	Tubo flexible	BG-22P (1/2")	20
FAM-26		BG-26P (3/4")	20
FAM-34		BG-34P (1")	20
FAP-18	Tubo flexible /	BG-18P (3/8")	20
FAP-22	Tubo rígido de PVC	BG-22P (1/2")	20
FAP-26		BG-26P (3/4")	20
FAP-34		BG-34P (1")	20
FAB-18	Tubo flexible /	BG-18P (3/8")	20
FAB-22	Caja de distribución	BG-22P (1/2")	20
FAB-26		BG-26P (3/4")	20
FAB-34		BG-34P (1")	20

Adaptador "EASY TYPE" para tubos flexibles

PATENTADO



Material: Nylon 66 homologado (UL) 94V-2.

PATENTADO

Ref. ■ gris	Ref. ■ negro	Para tubos	
■ BGQ-16	■ BGQ-16BK	BG-16P	50
■ BGQ-18	■ BGQ-18BK	BG-18P	50
■ BGQ-20	■ BGQ-20BK	BG-20P	50
■ BGQ-22	■ BGQ-22BK	BG-22P	50
■ BGQ-25	■ BGQ-25BK	BG-25P	50
■ BGQ-26	■ BGQ-26BK	BG-26P	50
■ BGQ-32	■ BGQ-32BK	BG-32P	50
■ BGQ-34	■ BGQ-34BK	BG-34P	50

Adaptador para tubos flexibles de metal



Material: ABS. Color: ■ Gris.

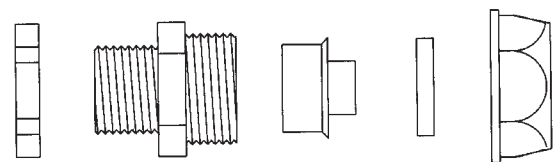

Ref.	mm	Para tubos	
MG-18	21.7	1/2"	50
MG-26	27.2	3/4"	50
MG-32	34.0	1"	25
MG-41	42.7	1 1/4"	25

Tubo flexible cerrado de NYLON

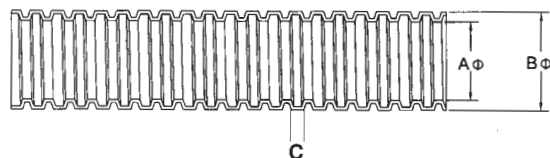

Material: NYLON. Color: ■ Negro.

Diseño cerrado. Para la protección de cables en maquinaria, construcción, etc.
 Su flexibilidad facilita la instalación de cableados.

Ref.	Dimensiones mm.			
	Aφ	Bφ	C	
PA-07	6.6±0.4	10.0±0.4	2.4	50m
PA-10	9.8±0.4	13.0±0.4	2.0	50m
PA-12	12.2±0.4	15.8±0.4	2.1	50m
PA-17	16.8±0.4	21.7±0.4	2.3	50m
PA-23	23.0±0.4	28.5±0.4	2.3	50m
PA-29	28.6±0.4	34.4±0.4	2.5	50m
PA-36	35.8±0.5	42.5±0.5	2.0	25m
PA-48	47.5±0.5	54.5±0.5	2.0	25m

Tubo flexible cerrado

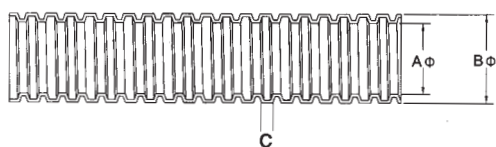
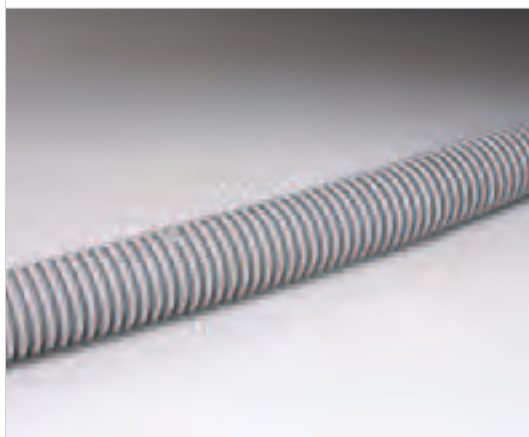

Material: PE ■ gris o NYLON ■ negro.

Ref. PE Gris	Ref. NYLON Negro	Dimensiones mm.			
		Aφ	Bφ	C	
■ BG-10P	■ BGN-10PBK	7.4±0.4	10.2±0.4	2.64	300m
■ BG-14P	■ BGN-14PBK	10.7±0.4	14.1±0.4	2.04	100m
■ BG-16P	■ BGN-16PBK	10.7±0.4	16.0±0.4	3.30	100m
■ BG-18P	■ BGN-18PBK	13.8±0.4	17.5±0.4	3.10	100m
■ BG-20P	■ BGN-20PBK	14.1±0.4	20.0±0.4	3.70	100m
■ BG-22P	■ BGN-22PBK	17.2±0.4	22.0±0.4	3.10	100m
■ BG-25P	■ BGN-25PBK	18.3±0.4	25.0±0.4	4.10	100m
■ BG-26P	■ BGN-26PBK	21.2±0.4	25.8±0.4	3.10	100m
■ BG-32P	■ BGN-32PBK	24.3±0.4	32.0±0.4	3.61	50m
■ BG-34P	■ BGN-34PBK	28.7±0.4	34.0±0.4	3.10	50m
■ BG-40P	■ BGN-40PBK	31.2±0.4	40.0±0.4	4.12	50m
■ BG-42P	■ BGN-42PBK	34.9±0.4	42.0±0.4	3.10	50m
■ BG-48P	■ BGN-48PBK	40.0±0.5	48.0±0.5	2.85	50m
■ BG-50P	■ BGN-50PBK	39.6±0.5	50.0±0.5	4.85	50m
■ BG-60P	■ BGN-60PBK	52.0±0.5	60.0±0.5	5.80	50m
■ BG-76P	■ BGN-76PBK	62.0±0.5	76.0±0.5	5.80	50m
■ BG-89P	■ BGN-89PBK	80.0±0.5	89.0±0.5	5.80	50m

Tubo flexible abierto y cerrado

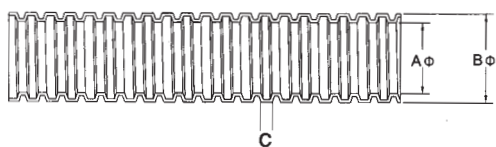

Material: Material: PE o NYLON.

Color: ■ Negro.

Ref. PE Abierto	Ref. NYLON Cerrado	Dimensiones mm.			
		A Ø	B Ø	C	
CR-1007P	CRS-1007P	7.4±0.4	10.2±0.4	2.60	300m
CR-1011SP	CRS-1011SP	10.7±0.4	14±0.4	1.10	200m
CR-1011P	CRS-1011P	10.7±0.4	16.0±0.4	3.30	200m
CR-1013P	CRS-1013P	13.8±0.4	17.5±0.4	3.10	200m
CR-1015P	CRS-1015P	15.0±0.4	19.5±0.4	3.50	100m
CR-1017P	CRS-1017P	17.2±0.4	22.0±0.4	3.10	100m
CR-1019P	CRS-1019P	19.3±0.4	23.8±0.4	3.50	100m
CR-1022P	CRS-1022P	21.2±0.4	25.8±0.4	3.10	100m
CR-1024P	CRS-1024P	24.3±0.4	32.0±0.4	3.61	50m
CR-1025P	CRS-1025P	25.0±0.4	30.0±0.4	4.10	50m
CR-1028P	CRS-1028P	28.0±0.4	34.0±0.4	3.10	50m
CR-1032P	CRS-1032P	31.2±0.4	40.0±0.4	4.12	50m
CR-1035P	CRS-1035P	34.9±0.4	42.0±0.4	3.10	50m
CR-1040P	CRS-1040P	39.6±0.5	50.0±0.5	4.85	50m
CR-1052P	CRS-1052P	52.0±0.5	60.0±0.5	5.8	50m
CR-1062P	CRS-1062P	62.0±0.5	76.0±0.5	5.8	50m
CR-1080P	CRS-1080P	80.0±0.5	89.0±0.5	5.8	50m

Tubo flexible cerrado, empotrable

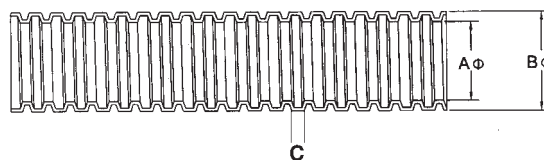

Material: H.D.P.E. Color: ■ Negro.

Aplicaciones: Para proteger los cables en instalaciones empotradas.

Diseño flexible para el mejor deslizamiento de los cables. **Diseño cerrado.**

Ref.	Dimensiones mm.			
	A Ø	B Ø	C	
CF-14P	10.7±0.4	14.1±0.4	2.04	100m
CF-18P	13.8±0.4	17.5±0.4	3.2	100m
CF-22P	17.2±0.4	22.0±0.4	3.2	100m
CF-26P	21.2±0.4	25.8±0.4	3.2	100m
CF-34P	28.7±0.4	34.0±0.4	3.2	50m
CF-42P	34.9±0.4	42.0±0.4	3.2	50m

Tubo metálico flexible

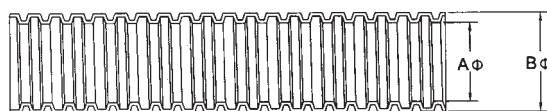

Color: Negro. ■

Ref.	Dimensiones mm.		Para cable	
	A Ø	B Ø		
MCR-02	6.5	11.0	NBG-02	100m
MCR-03	10.0	14.4	NBG-03	50m
MCR-04	12.8	17.5	NBG-04	50m
MCR-05	16.0	20.8	NBG-05	50m
MCR-06	20.2	25.5	NBG-06	50m
MCR-08	26.2	32.4	NBG-08	25m
MCR-10	32.5	39.0	NBG-10	25m
MCR-12	39.3	46.2	NBG-12	25m
MCR-16	51.3	59.5	NBG-16	25m
MCR-20	62.9	72.2	NBG-20	10m
MCR-24	77.5	88.9	NBG-24	1m
MCR-32	101.6	113.9	NBG-32	1m