

## Conjunto "KITS" de conectores estancos serie XBDT

Conectores macho

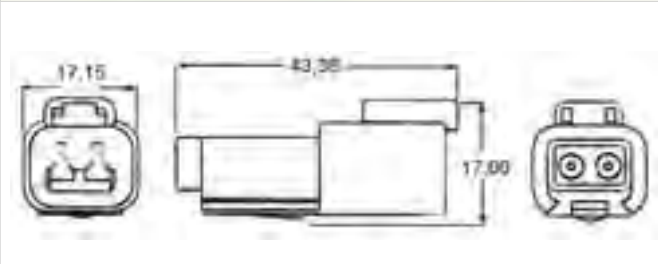

**XBDT-04-2P**

**2 vías**

☞ : 1 / 10

Conectores hembra

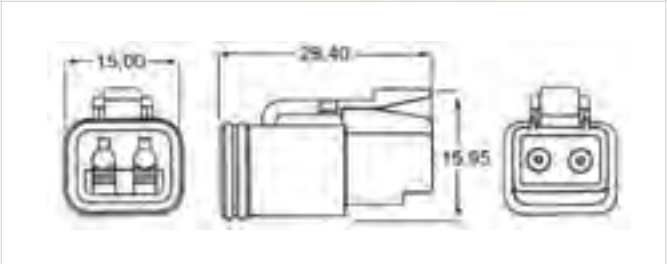

**XBDT-06-2S**

**2 vías**

☞ : 1 / 10

Conectores macho

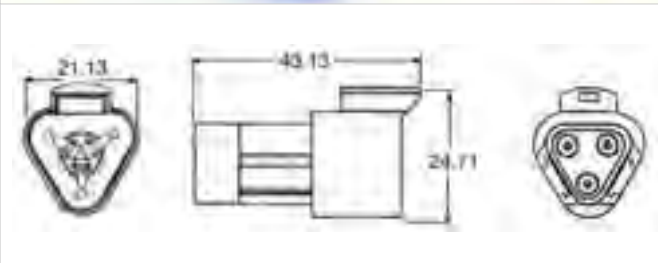

**XBDT-04-3P**

**3 vías**

☞ : 1 / 10

Conectores hembra

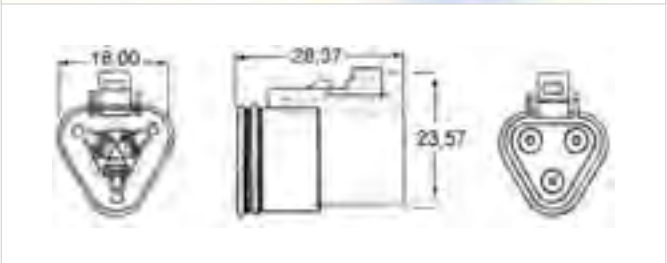

**XBDT-06-3S**

**3 vías**

☞ : 1 / 10

Conectores macho

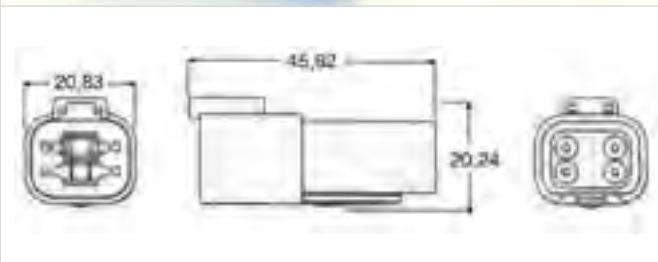

**XBDT-04-4P**

**4 vías**

☞ : 1 / 10

Conectores hembra

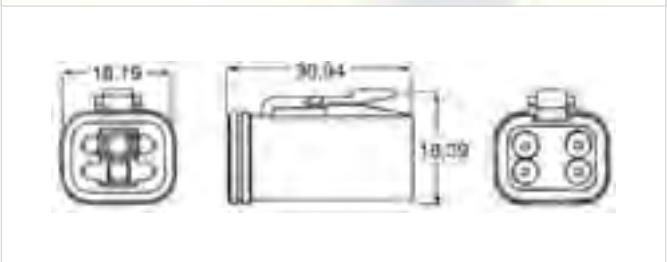

**XBDT-06-4S**

**4 vías**

☞ : 1 / 10

## Conjunto "KITS" de conectores estancos serie XBDT

Conectores macho

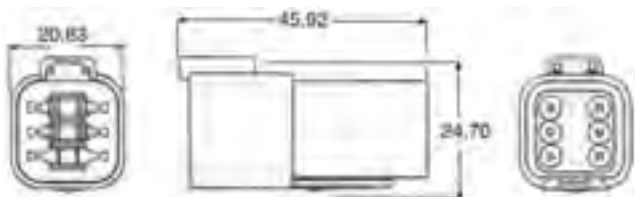

**XBDT-04-6P**

**6 vías**

☞ : 1 / 10

Conectores hembra

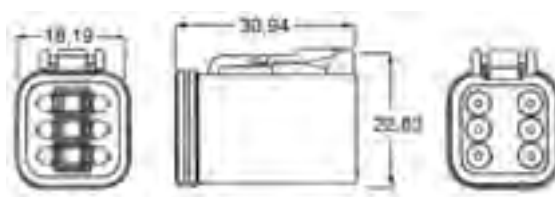

**XBDT-06-6S**

**6 vías**

☞ : 1 / 10

Conectores macho

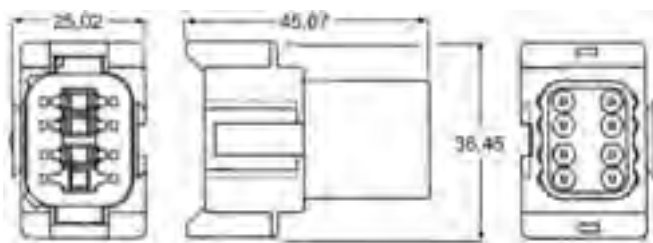

**XBDT-04-8PA**

**8 vías**

☞ : 1 / 10

Conectores hembra

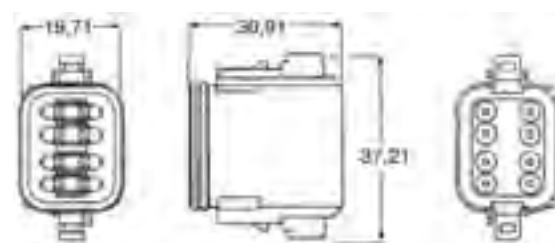

**XBDT-06-8SA**

**8 vías**

☞ : 1 / 10

Conectores macho

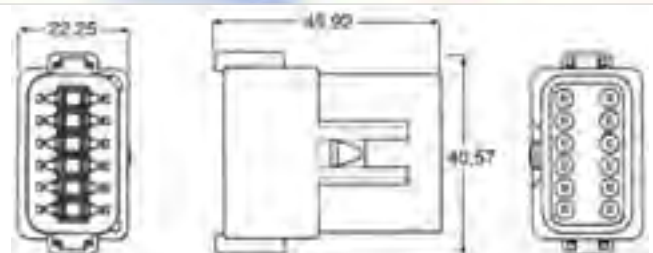

**XBDT-04-12PA**

**12 vías**

☞ : 1 / 10

Conectores hembra

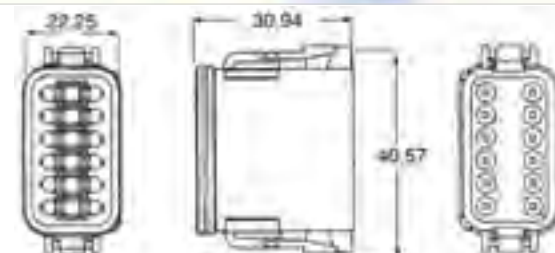

**XBDT-06-12SA**

**12 vías**

☞ : 1 / 10

## Conectores estancos serie XBDT

### REFERENCIAS UNITARIAS DE CONECTORES, SECONDARYLOCK Y TERMINALES

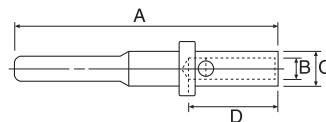
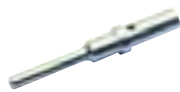

Conector macho	Nº vías	Secondarylock	Terminal macho	Dimensiones terminal mm.				
				A	B	C	D	
<b>DT-04-2P</b>	2	<b>W2P</b>	0,5 ~ 1,0	<b>460202.16141</b>	20,85	1,68	2,62	6,35
			1,0 ~ 2,0	<b>460215.16141</b>	20,85	1,93	2,62	6,35
<b>DT-04-3P</b>	3	<b>W3P</b>	0,5 ~ 1,0	<b>460202.16141</b>	20,85	1,68	2,62	6,35
			1,0 ~ 2,0	<b>460215.16141</b>	20,85	1,93	2,62	6,35
<b>DT-04-4P</b>	4	<b>W4P</b>	0,5 ~ 1,0	<b>460202.16141</b>	20,85	1,68	2,62	6,35
			1,0 ~ 2,0	<b>460215.16141</b>	20,85	1,93	2,62	6,35
<b>DT-04-6P</b>	6	<b>W6P</b>	0,5 ~ 1,0	<b>460202.16141</b>	20,85	1,68	2,62	6,35
			1,0 ~ 2,0	<b>460215.16141</b>	20,85	1,93	2,62	6,35
<b>DT-04-8PA</b>	8	<b>W8PA</b>	0,5 ~ 1,0	<b>460202.16141</b>	20,85	1,68	2,62	6,35
			1,0 ~ 2,0	<b>460215.16141</b>	20,85	1,93	2,62	6,35
<b>DT-04-12PA</b>	12	<b>W12PA</b>	0,5 ~ 1,0	<b>460202.16141</b>	20,85	1,68	2,62	6,35
			1,0 ~ 2,0	<b>460215.16141</b>	20,85	1,93	2,62	6,35

 : 100

 : 100

 : 500

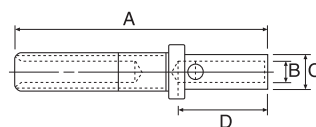

Conector hembra	Nº vías	Secondarylock	Terminal hembra	Dimensiones terminal mm.				
				A	B	C	D	
<b>DT-04-2S</b>	2	<b>W2S</b>	0,5 ~ 1,0	<b>462201.16141</b>	19,28	1,68	2,62	6,35
			1,0 ~ 2,0	<b>462209.16141</b>	19,23	1,93	2,62	6,35
<b>DT-04-3S</b>	3	<b>W3S</b>	0,5 ~ 1,0	<b>462201.16141</b>	19,28	1,68	2,62	6,35
			1,0 ~ 2,0	<b>462209.16141</b>	19,23	1,93	2,62	6,35
<b>DT-04-4S</b>	4	<b>W4S</b>	0,5 ~ 1,0	<b>462201.16141</b>	19,28	1,68	2,62	6,35
			1,0 ~ 2,0	<b>462209.16141</b>	19,23	1,93	2,62	6,35
<b>DT-04-6S</b>	6	<b>W6S</b>	0,5 ~ 1,0	<b>462201.16141</b>	19,28	1,68	2,62	6,35
			1,0 ~ 2,0	<b>462209.16141</b>	19,23	1,93	2,62	6,35
<b>DT-04-8SA</b>	8	<b>W8SA</b>	0,5 ~ 1,0	<b>462201.16141</b>	19,28	1,68	2,62	6,35
			1,0 ~ 2,0	<b>462209.16141</b>	19,23	1,93	2,62	6,35
<b>DT-04-12SA</b>	12	<b>W12SA</b>	0,5 ~ 1,0	<b>462201.16141</b>	19,28	1,68	2,62	6,35
			1,0 ~ 2,0	<b>462209.16141</b>	19,23	1,93	2,62	6,35

 : 100

 : 100

 : 500

## Conectores estancos serie XBDT



**HDT-48-00**

Herramientas para engaste de terminales.

 : 1



**0411.204.1605**

Útil para la extracción de terminales

 : 1



## Conectores estancos

“SUPER SEAL” SERIE 1,5 mm.

Material: PA 66

### Terminal macho



**SERIE 1,5 SUPERSEAL**

Ref.	Sección cable mm <sup>2</sup>	Dimensiones mm.	
<b>11.05530-32</b>	0,3-0,5	1,5 x 7 x 22,7	100
<b>11.05550-32</b>	1-1,5	1,5 x 7 x 22,7	100

### Terminal hembra



**SERIE 1,5 SUPERSEAL**

Ref.	Sección cable mm <sup>2</sup>	Dimensiones mm.	
<b>11.05540-32</b>	0,3-0,5	1,5 x 7 x 16,5	100
<b>11.05560-32</b>	1-1,5	1,5 x 7 x 16,5	100

Para terminal macho

■ **44.23610** 1 vía : 10 / 100

Para terminal hembra

■ **44.23620** 1 vía : 10 / 100

Para terminal macho

■ **44.23630** 2 vías : 10 / 100

Para terminal hembra

■ **44.23640** 2 vías : 10 / 100

## Conectores estancos - "SUPER SEAL" SERIE 1,5 mm.

Para terminal macho 



■ **44.23650** 3 vías ☞ : 10 / 100

Para terminal hembra 



■ **44.23660** 3 vías ☞ : 10 / 100

Para terminal macho 



■ **44.23670** 4 vías ☞ : 5 / 50

Para terminal hembra 



■ **44.23680** 4 vías ☞ : 5 / 50

Para terminal macho 



■ **44.23690** 5 vías ☞ : 5 / 50

Para terminal hembra 



■ **44.23700** 5 vías ☞ : 5 / 50

Para terminal macho 



■ **44.23710** 6 vías ☞ : 5 / 50

Para terminal hembra 



■ **44.23720** 6 vías ☞ : 5 / 50

## Conectores estancos - "SUPER SEAL" SERIE 1,5 mm.



■ **44.23470** 2 vías  : 10 / 100



■ **44.23355** 3 vías  : 5 / 50



**SERIE 1,5 SUPERSEAL**

Ref.	Ø aislante mm.	Material	Color	
<b>44.07510</b>	1,4-1,7	Silicona	<span style="color: green;">■</span>	50



**SERIE 1,5 SUPERSEAL**

Ref.	Ø aislante mm.	Material	Color	
<b>44.07530</b>	2,6-3,3	Silicona	<span style="color: red;">■</span>	50



**SERIE 1,5 SUPERSEAL**

Ref.	Ø aislante mm.	Material	Color	
<b>44.07740</b>	1,8-2,4	Silicona	<span style="color: yellow;">■</span>	50



**TAPÓN DE CIERRE  
SERIE 1,5 SUPERSEAL**

Ref.	Ø aislante mm.	Material	Color	
<b>44.10659</b>	Tapón de cierre	Silicona	<span style="color: red;">■</span>	50



## Conectores estancos

"SUPER SEAL" SERIE 2,8 mm.

Terminal hembra	Ref.	Sección cable mm <sup>2</sup>	Dimensiones mm.	
	<b>11.04510-32</b>	0,5-1,5	2,8x8,7x19,9	50
	<b>11.04530-32</b>	1,5-2,5	2,8x8,7x19,9	50
Terminal macho	Ref.	Sección cable mm <sup>2</sup>	Dimensiones mm.	
	<b>11.04500-32</b>	0,5-1,5	2,8x3,82x32,7	50
	<b>11.04520-32</b>	1,5-2,5	2,8x3,82x32,7	50

Para terminal macho

■ **44.23520** 1 vía : 5 / 50

Para terminal hembra

■ **44.23510** 1 vía : 5 / 50

Para terminal macho

■ **44.23540** 2 vías : 5 / 50

Para terminal hembra

■ **44.23530** 2 vías : 5 / 50

Para terminal macho



■ **44.23560** 3 vías : 5 / 50

Para terminal hembra

■ **44.23550** 3 vías : 5 / 50



## Conectores estancos - "SUPER SEAL" SERIE 2,8 mm.

**SERIE 2,8 SUPERSEAL**

Ref.	Ø aislante mm.	Material	Color	
<b>44.33561</b>	1,29-2,06	Silicona	<span style="color: red;">■</span>	50



**SERIE 2,8 SUPERSEAL**

Ref.	Ø aislante mm.	Material	Color	
<b>44.33559</b>	2,8-3,5	Silicona	<span style="color: darkgray;">■</span>	50





**SERIE 2,8 SUPERSEAL**

Ref.	Ø aislante mm.	Material	Color	
<b>44.33558</b>	1,5-2,4	Silicona	<span style="color: purple;">■</span>	50





**SERIE 2,8 SUPERSEAL**

Ref.	Ø aislante mm.	Material	Color	
<b>44.33560</b>	3,5-4,21	Silicona	<span style="color: blue;">■</span>	50

**SERIE 2,8 SUPERSEAL**

Ref.	Ø aislante mm.	Material	Color	
<b>44.33562</b>	2,03-2,8	Silicona	<span style="color: green;">■</span>	50

## KIT conector estanco - "SUPER SEAL" SERIE 6,3 mm.

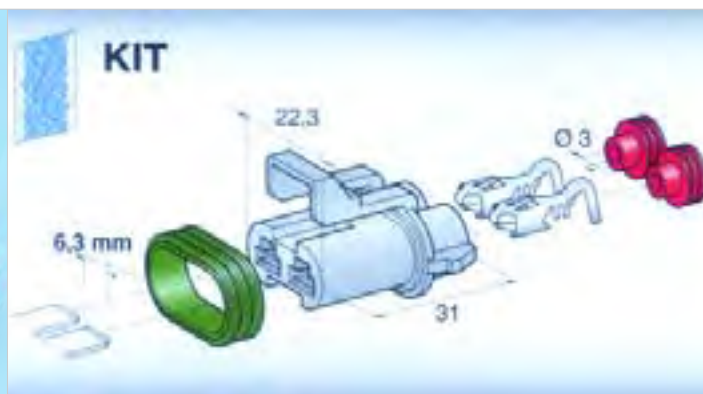

■ **44.33800**

**2 vías.** Material: PA 66. Terminales: Bronce fosforoso estañado.

Sección cable: 1.0~2.0 mm<sup>2</sup>

📦 : 1 / 250

## KIT de puerta, con conectores y terminales

■ **30.50141**

**KIT PARA PUERTA TRASERA**



Material: PA 66 - 6F

Conector con Secondarylock .....1 u.

Terminal Ref. **11.08420** .....10 u.

Gomino Ref. **44.10658** .....10 u.

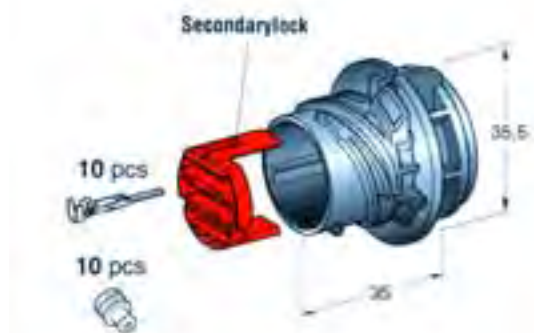

■ **30.50140**

**KIT PARA PUERTA DELANTERA**



Material: PA 66 - 6F

Conector con Secondarylock .....1 u.

Terminal Ref. **11.08410** .....29 u.

Gomino Ref. **44.10658** .....29 u.

